

- Wash your hands with soap and water.

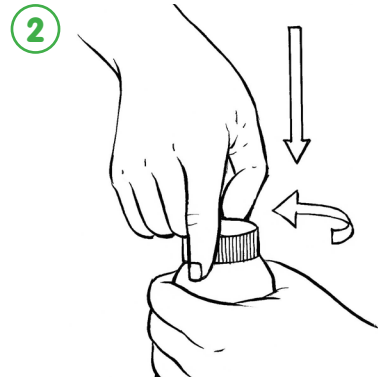

- Open the bottle by pushing the cap down while turning to the left.

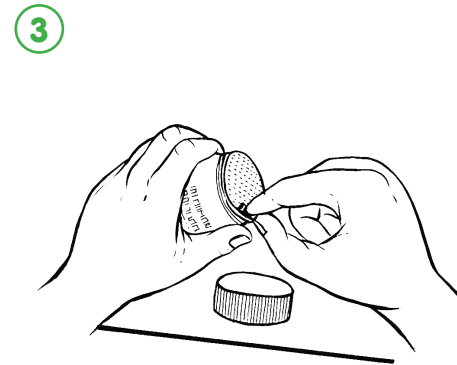

- The first time the bottle is opened, there will be a seal covering the bottle.
- Remove and discard this seal.

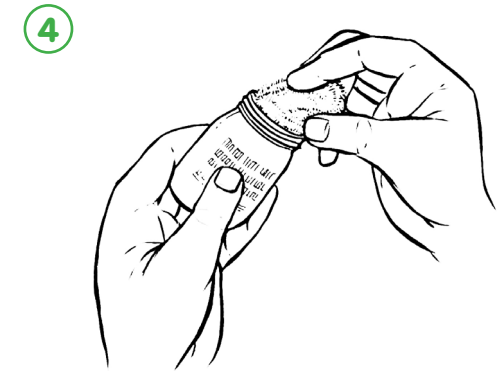

- Inside the bottle, there will be cotton wool.
- Remove and discard this cotton wool.

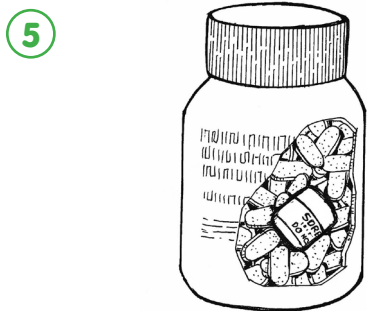

- There is a sealed container inside the bottle that helps keep the tablets dry.
- Do not open this container, swallow it, or remove it from the bottle.

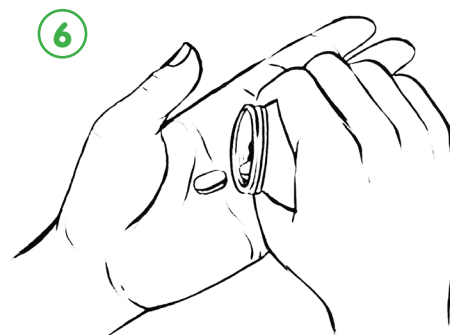

- Remove one tablet from the bottle when taking one tablet each day.

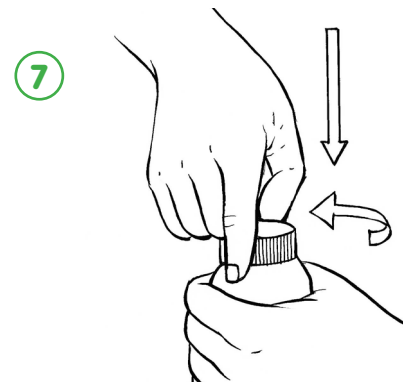

- After removing the tablet, close the bottle tightly by replacing the cap and turning it to the right.



- Put one tablet in your mouth and swallow it with water or other non-alcoholic beverage.

- **Take one dose (one tablet) by mouth every day**
 - Take one dose at the same time each day
 - It may be taken with or without a meal
- **It is important that you do not miss any doses**
 - If you forget to take a dose, take one tablet as soon as you remember
 - If you forget to take a dose, and your next dose is due within 6 hours, skip the missed dose
 - Do not take more than 1 dose in a day
- **Keep all tablets in your possession**
 - Do not remove labels from the bottle
 - Keep the tablets in a safe place and out of the reach of children
 - Store at room temperature
 - Keep the tablets in its original container and keep the container tightly closed
- **Do not share your tablets with other people**
 - Use only the tablets assigned to you
 - Do not use the tablets if the seal of the bottle opening is broken or missing when taking the first dose.
- **Return remaining unused tablets to the study staff at your next visit**
- **The study staff is here to help and support you. Please contact study staff if you have:**
 - Any questions or concerns
 - If your supply starts to run low
 - Problems taking the tablets. Do not change how much you are taking or stop taking your pills without first talking with study staff
 - New symptoms or worsening of any continuing medical symptoms